

FLYER

FLYER E-Mountainbike Uproc2, Uproc4 und Uproc7

mit Panasonic Antrieb

FIT FLYER
INTELLIGENT
TECHNOLOGY



DE

FR

IT

EN

NL

- de Technische Daten für Uproc2, Uproc4 und Uproc7
- fr Caractéristiques techniques des séries Uproc2, Uproc 4 et Uproc7
- it Dati tecnici per Uproc2, Uproc4 e Uproc7
- en Technical data for Uproc2, Uproc4 and Uproc7
- nl Technische gegevens voor Uproc2, Uproc4 en Uproc7

Der FLYER und seine Bauteile

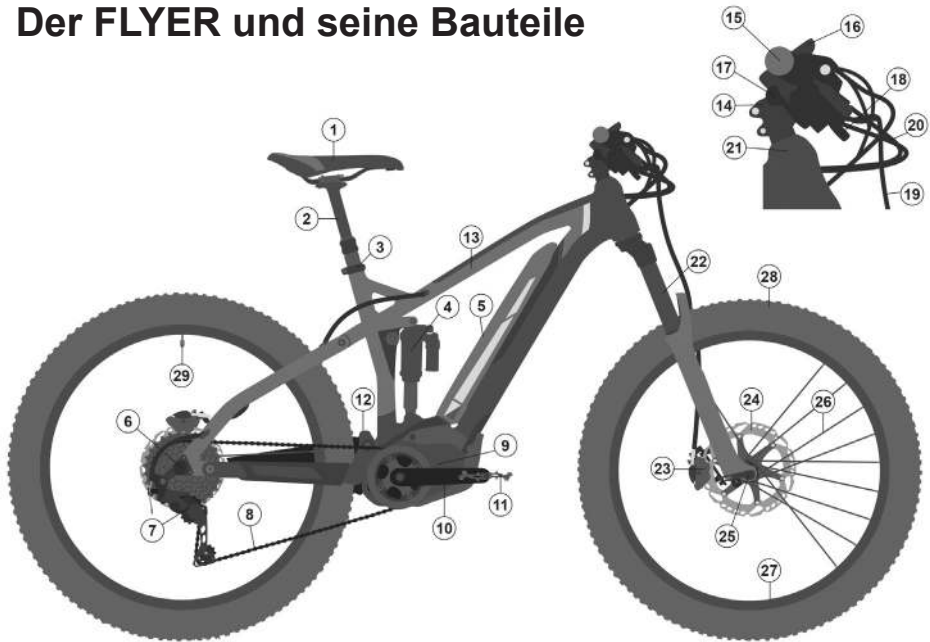

- | | |
|----------------------------------|----------------------------------|
| ① Sattel | ①⑦ Schaltgriff |
| ② Sattelstütze | ①⑧ Bremsgriff |
| ③ Sattelstützklemme | ①⑨ Bremszug/-leitung |
| ④ Federelement Hinterbau/Dämpfer | ①⑩ Schaltzug |
| ⑤ Akku | ①⑪ Lenkungslager oder Steuersatz |
| ⑥ Ausfallende | ①⑫ Federgabel |
| ⑦ Schaltwerk | ①⑬ Scheibenbremsattel |
| ⑧ Kette | ①⑭ Brems Scheibe |
| ⑨ Elektrischer Antrieb | |
| ⑩ Kurbelarm | Lauf rad |
| ⑪ Pedal | ①⑮ Vorderradnabe |
| ⑫ Drehpunkte/Lager | ①⑯ Speiche |
| ⑬ Rahmen | ①⑰ Felge |
| ⑭ Vorbau | ①⑱ Reifen |
| ⑮ Lenker mit Griff | ①⑲ Ventil |
| ⑯ Display | |

Technische Daten für Uproc2, Uproc4 und Uproc7 Modelljahr 2017

Bitte beachten Sie die nachfolgenden technischen Daten, wenn Sie einen FLYER aus dem Modelljahr 2017 erworben haben. Die technischen Daten in der Hauptbedienungsanleitung haben für diese Modelle keine Gültigkeit.

Gewicht der FLYER (ohne Akku)

| | |
|----------|--------|
| – Uproc2 | 21 kg* |
| – Uproc4 | 22 kg* |
| – Uproc7 | 22 kg* |

*Das tatsächliche Gewicht hängt von Rahmentyp, -grösse und Ausstattung ab.

FLYER sind ausgelegt für ein maximales Gesamtgewicht (Fahrer, Gepäck, Fahrzeug und Akku) von 130 kg.

Akkus zu den FLYER Modellen

| Kapazität | Energieinhalt | Gewicht |
|------------------------------------|---------------|----------------------|
| SIB Smart Integrated Battery 8 Ah | 288 Wh | 2.3 kg Rahmenakku |
| SIB Smart Integrated Battery 12 Ah | 432 Wh | 3.1 kg Rahmenakku |

DE

Ausführungen Panasonic Mittelmotor

| Motor | Tretunterstützung bis | Neendauerleistung in Watt | Max. Output Kettenschaltung in Watt | Max. Unterstützung Kettenschaltung in % | Max. Drehmoment Kettenschaltung in Nm |
|--------------------------|-----------------------|---------------------------|-------------------------------------|---|---------------------------------------|
| (2-Gang) 36V Multi Speed | 25 km/h | 250 | 600 | 300 | 66 |
| (2-Gang) 36V Multi Speed | 45 km/h | 250 | 600 | 300 | 75 |

Anzugsdrehmomente für Schraubverbindungen

| Angaben in Nm | | Uproc2 | | | Uproc4 | | | Uproc7 | | |
|---------------|----------------------------|--------|--------|-------|--------|-------|-------|--------|-------|-------|
| | | 4.10 | 6.30 | 8.70 | 4.10 | 6.30 | 8.70 | 4.10 | 6.30 | 8.70 |
| Cockpit | Lenkergriffe | 3 | 3 | 3 | 3 | 2 | 2 | 2 | 2 | 2 |
| | Bremshebel | 4 | 4 | 6-8 | 4 | 6-8 | 6-8 | 4 | 6-8 | 6-8 |
| | Schalthebel | 3 | 3 | 3 | 3 | 3 | 3 | 3 | 3 | 3 |
| | Display Halter | 1 | 1 | 1 | 1 | 1 | 1 | 1 | 1 | 1 |
| | Remote Display | 1 | 1 | 1 | 1 | 1 | 1 | 1 | 1 | 1 |
| | Lenker auf Vorbau | 5-6 | 5-6 | 5-6 | 5-6 | 5-6 | 5-6 | 5-6 | 5-6 | 5-6 |
| | Vorbau auf Gabelschaft | 5-6 | 5-6 | 5-6 | 5-6 | 5-6 | 5-6 | 5-6 | 5-6 | 5-6 |
| | Motorschrauben | 30-35 | 30-35 | 30-35 | 30-35 | 30-35 | 30-35 | 30-35 | 30-35 | 30-35 |
| Antrieb | Kettenblattschrauben | 13 | 13 | 13 | 13 | 13 | 13 | 13 | 13 | 13 |
| | Kurbel | 50 | 50 | 50 | 50 | 50 | 50 | 50 | 50 | 50 |
| | Pedale | 34 | 34 | 34 | 34 | 34 | 34 | 34 | 34 | 34 |
| | Akkualterung | 6-8 | 6-8 | 6-8 | 6-8 | 6-8 | 6-8 | 6-8 | 6-8 | 6-8 |
| | Akkuschloss | 6-8 | 6-8 | 6-8 | 6-8 | 6-8 | 6-8 | 6-8 | 6-8 | 6-8 |
| | Wechsel/Kettenspanner | 8-10 | 8-10 | 8-10 | 8-10 | 8-10 | 8-10 | 8-10 | 8-10 | 8-10 |
| Hinterrahmen | Bremssattel/Scheibenbremse | 6 | 6 | 6-8 | 4 | 6-8 | 6-8 | 4 | 6-8 | 6-8 |
| | Kassette | 30-50 | 30-50 | 30-50 | 30-50 | 30-50 | 30-50 | 30-50 | 30-50 | 30-50 |
| Sattel | Sattelgestell | 12 (8) | 12 (8) | 8 | 12 (8) | 8 | 10 | 12 (8) | 8 | 10 |
| | Sattelstützenklemme | 6-7 | 6-7 | 6-7 | 6-7 | 6-7 | 6-7 | 6-7 | 6-7 | 6-7 |
| Hinterbau | Rocker auf Sitzrohr | - | - | - | 8-10 | 8-10 | 8-10 | 8-10 | 8-10 | 8-10 |
| | Restliche Schrauben | - | - | - | 13-15 | 13-15 | 13-15 | 13-15 | 13-15 | 13-15 |

- () Drehmomente in Klammer gelten für optional wählbare Komponenten.
- Durch Nichteinhalten der vorgeschriebenen Drehmomente können Bauteile beschädigt werden. Halten Sie sich deshalb immer an das angegebene Anzugsdrehmoment.
- Zum Anziehen der Schraubverbindungen muss ein Drehmomentschlüssel verwendet werden. Nicht korrekt angezogene Teile können sich lösen oder brechen.

Le FLYER et ses composants

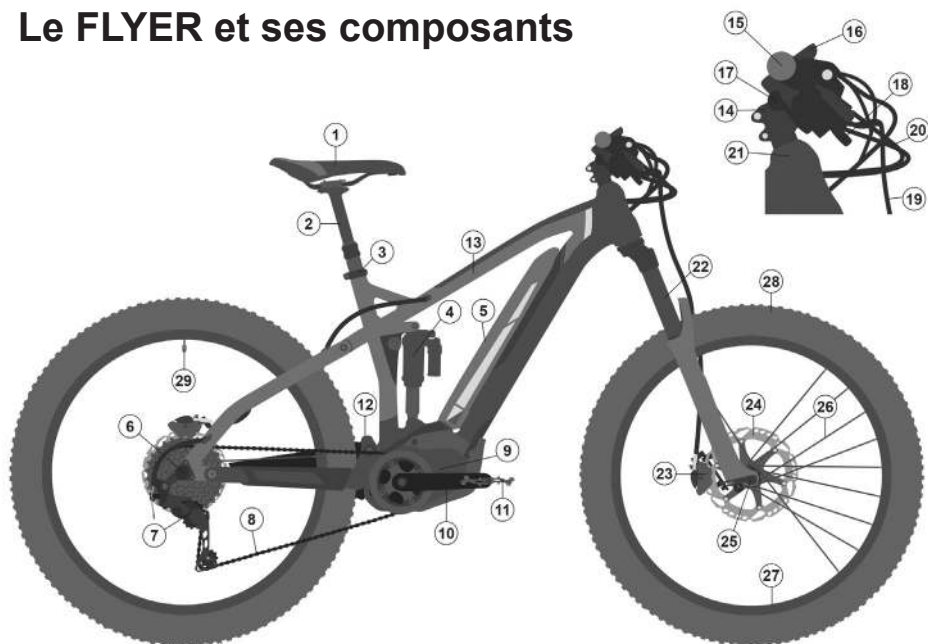

- ① Selle
 - ② Tige de selle
 - ③ Collier de selle
 - ④ Ressort triangle arrière/amortisseur
 - ⑤ Batterie
 - ⑥ Patte de dérailleur
 - ⑦ Dérailleur
 - ⑧ Chaîne
 - ⑨ Entraînement électrique
 - ⑩ Manivelle
 - ⑪ Pédale
 - ⑫ Pivots/paliers
 - ⑬ Cadre
 - ⑭ Potence
 - ⑮ Guidon avec poignée
 - ⑯ Écran
 - ⑰ Poignée tournante
 - ⑱ Poignée de frein
 - ⑲ Câble de frein
 - ⑳ Câble de commande
 - ㉑ Palier de direction
 - ㉒ Fourche suspendue
 - ㉓ Étrier de frein à disque
 - ㉔ Disque de frein
- Roue**
- ㉕ Moyeu de roue avant
 - ㉖ Rayon
 - ㉗ Jante
 - ㉘ Pneu
 - ㉙ Valve

Caractéristiques techniques Uproc2, Uproc4 et Uproc7 année modèle 2017

Si vous avez acheté un FLYER de l'année modèle 2017, ce sont les caractéristiques techniques ci-après qui sont applicables. Les caractéristiques techniques mentionnées dans le mode d'emploi principal ne sont pas valables pour ces modèles.

Les FLYER sont conçus pour un poids total (cycliste, bagages, vélo et batterie) de 130 kg.

Batteries adaptées aux modèles FLYER

Poids des FLYER (sans batterie)

| | |
|----------|--------|
| – Uproc2 | 21 kg* |
| – Uproc4 | 22 kg* |
| – Uproc7 | 22 kg* |

*Le poids réel dépend du type et de la taille du cadre ainsi que des équipements.

| Capacité | Contenu énergétique | Poids |
|------------------------------------|---------------------|-----------------------------|
| SIB Smart Integrated Battery 8 Ah | 288 Wh | 2.3 kg Batterie de cadre |
| SIB Smart Integrated Battery 12 Ah | 432 Wh | 3.1 kg Batterie de cadre |

FR

Exécutions moteur central Panasonic

| Moteur | Assistance au pédalage jusqu'à | Puissance nominale continue en watts | Puissance maxi. dérailleur en watts | Assistance maxi. dérailleur en % | Couple maxi. dérailleur en Nm |
|-------------------------------|--------------------------------|--------------------------------------|-------------------------------------|----------------------------------|-------------------------------|
| (2 vitesses) 36 V Multi Speed | 25 km/h | 250 | 600 | 300 | 66 |
| (2 vitesses) 36 V Multi Speed | 45 km/h | 250 | 600 | 300 | 75 |

Couples de vissage

| en Nm | | Uproc2 | | | Uproc4 | | | Uproc7 | | |
|------------------------------|---------------------------------------|--------|--------|-------|--------|-------|-------|--------|-------|-------|
| | | 4.10 | 6.30 | 8.70 | 4.10 | 6.30 | 8.70 | 4.10 | 6.30 | 8.70 |
| Unité de commande | Poignées | 3 | 3 | 3 | 3 | 2 | 2 | 2 | 2 | 2 |
| | Manette de frein | 4 | 4 | 6-8 | 4 | 6-8 | 6-8 | 4 | 6-8 | 6-8 |
| | Manette de changement de vitesse | 3 | 3 | 3 | 3 | 3 | 3 | 3 | 3 | 3 |
| | Fixation de l'écran | 1 | 1 | 1 | 1 | 1 | 1 | 1 | 1 | 1 |
| | Remote Display | 1 | 1 | 1 | 1 | 1 | 1 | 1 | 1 | 1 |
| | Fixation du guidon sur la potence | 5-6 | 5-6 | 5-6 | 5-6 | 5-6 | 5-6 | 5-6 | 5-6 | 5-6 |
| | Fixation de la potence sur la fourche | 5-6 | 5-6 | 5-6 | 5-6 | 5-6 | 5-6 | 5-6 | 5-6 | 5-6 |
| | Vis de fixation du moteur | 30-35 | 30-35 | 30-35 | 30-35 | 30-35 | 30-35 | 30-35 | 30-35 | 30-35 |
| Entraînement | Vis de fixation des plateaux | 13 | 13 | 13 | 13 | 13 | 13 | 13 | 13 | 13 |
| | Manivelle | 50 | 50 | 50 | 50 | 50 | 50 | 50 | 50 | 50 |
| | Pédales | 34 | 34 | 34 | 34 | 34 | 34 | 34 | 34 | 34 |
| | Fixation de la batterie | 6-8 | 6-8 | 6-8 | 6-8 | 6-8 | 6-8 | 6-8 | 6-8 | 6-8 |
| | Antivol de batterie | 6-8 | 6-8 | 6-8 | 6-8 | 6-8 | 6-8 | 6-8 | 6-8 | 6-8 |
| Tendeur de vitesse/de chaîne | 8-10 | 8-10 | 8-10 | 8-10 | 8-10 | 8-10 | 8-10 | 8-10 | 8-10 | |
| Freins | Étrier de frein/frein à disque | 6 | 6 | 6-8 | 4 | 6-8 | 6-8 | 4 | 6-8 | 6-8 |
| | Cassette | 30-50 | 30-50 | 30-50 | 30-50 | 30-50 | 30-50 | 30-50 | 30-50 | 30-50 |
| Selle | Support de selle | 12 (8) | 12 (8) | 8 | 12 (8) | 8 | 10 | 12 (8) | 8 | 10 |
| | Collier de selle | 6-7 | 6-7 | 6-7 | 6-7 | 6-7 | 6-7 | 6-7 | 6-7 | 6-7 |
| Triangle arrière | Bras oscillant sur tube de selle | - | - | - | 8-10 | 8-10 | 8-10 | 8-10 | 8-10 | 8-10 |
| | Autres vis | - | - | - | 13-15 | 13-15 | 13-15 | 13-15 | 13-15 | 13-15 |

- () Les couples entre parenthèses correspondent aux équipements en option.
- Le non-respect des couples prescrits peut provoquer l'endommagement de composants. Respectez toujours le couple de serrage indiqué.
- Utilisez obligatoirement une clé dynamométrique pour le serrage des vis. Les pièces mal serrées peuvent se desserrer ou casser.

La FLYER e i suoi componenti

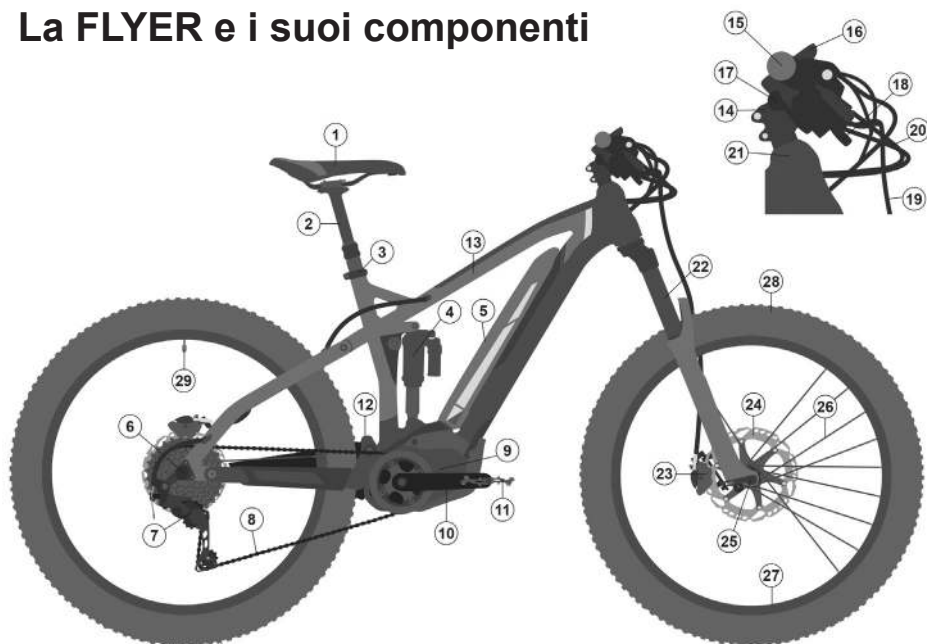

- ① Sella
- ② Reggisella
- ③ Morsetto del reggisella
- ④ Elemento della sospensione Parte posteriore/Ammortizzatore
- ⑤ Batteria
- ⑥ Portamozzo
- ⑦ Sistema di commutazione
- ⑧ Catena
- ⑨ Sistema propulsivo elettrico
- ⑩ Braccetto della pedivella
- ⑪ Pedale
- ⑫ Parti rotanti/Deposito
- ⑬ Telaio
- ⑭ Avancorpo
- ⑮ Manubrio con maniglia

- ⑯ Display
- ⑰ Leva del cambio
- ⑱ Leva del freno
- ⑲ Cavo/tubo del freno
- ⑳ Cavo di commutazione
- ㉑ Cuscinetto del manubrio o serie sterzo
- ㉒ Forcella di sospensione
- ㉓ Pinza freno a disco
- ㉔ Disco del freno

Ruota portante

- ㉕ Mozzo della ruota anteriore
- ㉖ Raggio
- ㉗ Cerchio
- ㉘ Copertone
- ㉙ Valvola

Dati tecnici per Uproc2, Uproc4 e Uproc7, modello 2017

In caso di acquisto di una FLYER modello 2017, si prega di prestare attenzione ai seguenti dati tecnici. I dati tecnici nelle istruzioni principali per l'uso non sono validi per questi modelli.

Le biciclette FLYER sono predisposte per un peso massimo complessivo (conducente, bagaglio, mezzo e batteria) di 130 kg.

Peso della FLYER (senza batteria)

| | |
|----------|--------|
| – Uproc2 | 21 kg* |
| – Uproc4 | 22 kg* |
| – Uproc7 | 22 kg* |

* Il peso effettivo dipende da tipo e dimensione del telaio e dall'allestimento.

Batterie per i modelli FLYER

| Capacità | Potenza | Peso |
|------------------------------------|---------|------------------------------|
| SIB Smart Integrated Battery 8 Ah | 288 Wh | 2.3 kg batteria su telaio |
| SIB Smart Integrated Battery 12 Ah | 432 Wh | 3.1 kg batteria su telaio |

IT

Versioni motore centrale Panasonic

| Motore | Pedalata assistita fino a | Potenza nominale continua in Watt | Max. output deragliatore in Watt | Max. supporto deragliatore in % | Max. coppia deragliatore in Nm |
|---------------------------|---------------------------|-----------------------------------|----------------------------------|---------------------------------|--------------------------------|
| (2 marce) 36V Multi Speed | 25 km/h | 250 | 600 | 300 | 66 |
| (2 marce) 36V Multi Speed | 45 km/h | 250 | 600 | 300 | 75 |

Coppie di serraggio per raccordi filettati

| Dati in Nm | | Uproc2 | | | Uproc4 | | | Uproc7 | | |
|--------------------|-----------------------------|--------|--------|-------|--------|-------|-------|--------|-------|-------|
| | | 4.10 | 6.30 | 8.70 | 4.10 | 6.30 | 8.70 | 4.10 | 6.30 | 8.70 |
| Cockpit | Maniglie del manubrio | 3 | 3 | 3 | 3 | 2 | 2 | 2 | 2 | 2 |
| | Leva del freno | 4 | 4 | 6-8 | 4 | 6-8 | 6-8 | 4 | 6-8 | 6-8 |
| | Leva del cambio | 3 | 3 | 3 | 3 | 3 | 3 | 3 | 3 | 3 |
| | Supporto del display | 1 | 1 | 1 | 1 | 1 | 1 | 1 | 1 | 1 |
| | Display remoto | 1 | 1 | 1 | 1 | 1 | 1 | 1 | 1 | 1 |
| | Manubrio sull'avancorpo | 5-6 | 5-6 | 5-6 | 5-6 | 5-6 | 5-6 | 5-6 | 5-6 | 5-6 |
| | Avancorpo sulla forcella | 5-6 | 5-6 | 5-6 | 5-6 | 5-6 | 5-6 | 5-6 | 5-6 | 5-6 |
| | Viti del motore | 30-35 | 30-35 | 30-35 | 30-35 | 30-35 | 30-35 | 30-35 | 30-35 | 30-35 |
| Sistema propulsivo | Viti del rocchetto | 13 | 13 | 13 | 13 | 13 | 13 | 13 | 13 | 13 |
| | Pedivelle | 50 | 50 | 50 | 50 | 50 | 50 | 50 | 50 | 50 |
| | Pedali | 34 | 34 | 34 | 34 | 34 | 34 | 34 | 34 | 34 |
| | Supporto della batteria | 6-8 | 6-8 | 6-8 | 6-8 | 6-8 | 6-8 | 6-8 | 6-8 | 6-8 |
| | Lucchetto della batteria | 6-8 | 6-8 | 6-8 | 6-8 | 6-8 | 6-8 | 6-8 | 6-8 | 6-8 |
| Cambio/Tendicatena | 8-10 | 8-10 | 8-10 | 8-10 | 8-10 | 8-10 | 8-10 | 8-10 | 8-10 | |
| Freni | Pinza freno/Freni a disco | 6 | 6 | 6-8 | 4 | 6-8 | 6-8 | 4 | 6-8 | 6-8 |
| | Cassetta | 30-50 | 30-50 | 30-50 | 30-50 | 30-50 | 30-50 | 30-50 | 30-50 | 30-50 |
| Sella | Telaio della sella | 12 (8) | 12 (8) | 8 | 12 (8) | 8 | 10 | 12 (8) | 8 | 10 |
| | Fascetta reggisella | 6-7 | 6-7 | 6-7 | 6-7 | 6-7 | 6-7 | 6-7 | 6-7 | 6-7 |
| Parte posteriore | Rocker sul tubo della sella | - | - | - | 8-10 | 8-10 | 8-10 | 8-10 | 8-10 | 8-10 |
| | Altre viti | - | - | - | 13-15 | 13-15 | 13-15 | 13-15 | 13-15 | 13-15 |

– () Le coppie di serraggio tra parentesi sono valide per componenti optional.

– Il mancato rispetto delle coppie di serraggio prescritte potrebbe arrecare danni ai componenti.

Pertanto, occorre attenersi sempre alla coppia di serraggio indicata.

– Per serrare i raccordi a vite è necessaria una chiave dinamometrica.

Le parti non serrate correttamente potrebbero allentarsi o rompersi.

The FLYER and its parts

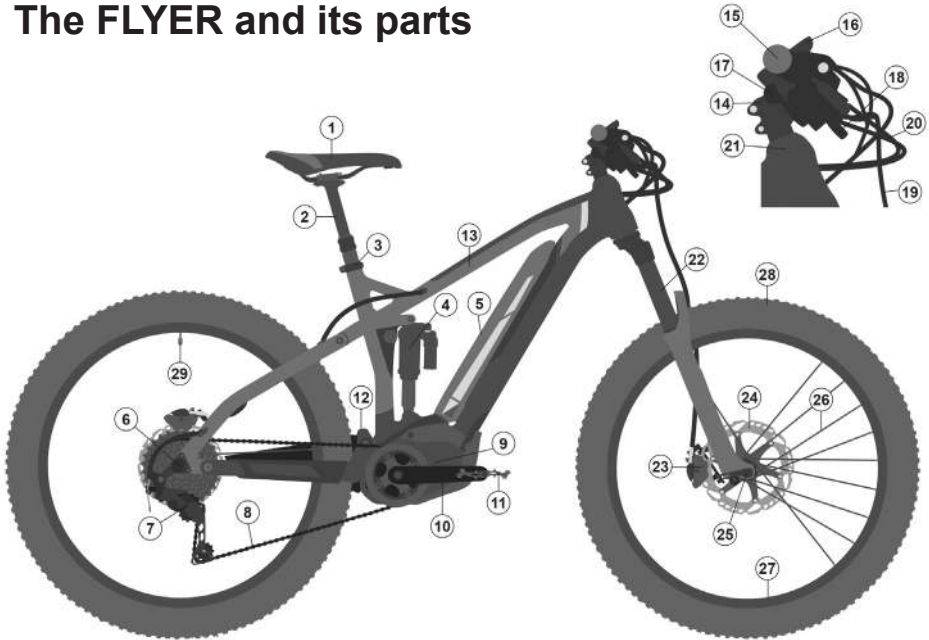

- ① Saddle
 - ② Seat post
 - ③ Seat post clamp
 - ④ Suspension rear fork/shock
 - ⑤ Battery
 - ⑥ Fork end
 - ⑦ Rear derailleur
 - ⑧ Chain
 - ⑨ Electrical motor
 - ⑩ Crank arm
 - ⑪ Pedal
 - ⑫ Pivot points/bearings
 - ⑬ Frame
 - ⑭ Stem
 - ⑮ Handlebars with handle
 - ⑯ Display
 - ⑰ Shift lever
 - ⑱ Brake lever
 - ⑲ Brake cable/line
 - ⑳ Shift cable
 - ㉑ Headset
 - ㉒ Suspension fork
 - ㉓ Disc brake calliper
 - ㉔ Brake disc
- Wheel**
- ㉕ Front hub
 - ㉖ Spoke
 - ㉗ Rim
 - ㉘ Tyre
 - ㉙ Valve

Technical data for Uproc2, Uproc4 and Uproc7, model year 2017

Please observe the following technical data if you have purchased a FLYER from model year 2017. The technical data in the main instruction manual do not apply to these models.

The FLYER is designed for a maximum overall weight (rider, luggage, bicycle and battery) of 130 kg.

Weight of the FLYER (not including battery)

| | |
|----------|--------|
| – Uproc2 | 21 kg* |
| – Uproc4 | 22 kg* |
| – Uproc7 | 22 kg* |

* The actual weight depends on the frame type and size and the accessories.

Batteries for the FLYER models

| Capacity | Energy content | Weight |
|------------------------------------|----------------|-------------------------|
| SIB Smart Integrated Battery 8 Ah | 288 Wh | 2.3 kg frame battery |
| SIB Smart Integrated Battery 12 Ah | 432 Wh | 3.1 kg frame battery |

Panasonic mid-drive motor types

| Motor | Pedal assist up to | Continuous rated power in watts | Max. output derailleur gears in watts | Maximum assistance derailleur gears in % | Max. torque Chain gears in Nm |
|--------------------------|--------------------|---------------------------------|---------------------------------------|--|-------------------------------|
| (2-gear) 36V Multi Speed | 25 km/h | 250 | 600 | 300 | 66 |
| (2-gear) 36V Multi Speed | 45 km/h | 250 | 600 | 300 | 75 |

EN

Tightening torques for screw connections

| Figures in Nm | | Uproc2 | | | Uproc4 | | | Uproc7 | | |
|---------------|------------------------------|--------|--------|-------|--------|-------|-------|--------|-------|-------|
| | | 4.10 | 6.30 | 8.70 | 4.10 | 6.30 | 8.70 | 4.10 | 6.30 | 8.70 |
| Cockpit | Handlebar grips | 3 | 3 | 3 | 3 | 2 | 2 | 2 | 2 | 2 |
| | Brake lever | 4 | 4 | 6-8 | 4 | 6-8 | 6-8 | 4 | 6-8 | 6-8 |
| | Gear shift lever | 3 | 3 | 3 | 3 | 3 | 3 | 3 | 3 | 3 |
| | Display holder | 1 | 1 | 1 | 1 | 1 | 1 | 1 | 1 | 1 |
| | Remote display | 1 | 1 | 1 | 1 | 1 | 1 | 1 | 1 | 1 |
| | Handlebars on stem | 5-6 | 5-6 | 5-6 | 5-6 | 5-6 | 5-6 | 5-6 | 5-6 | 5-6 |
| | Stem on fork shaft | 5-6 | 5-6 | 5-6 | 5-6 | 5-6 | 5-6 | 5-6 | 5-6 | 5-6 |
| | Motor screws | 30-35 | 30-35 | 30-35 | 30-35 | 30-35 | 30-35 | 30-35 | 30-35 | 30-35 |
| Motor | Chain ring screws | 13 | 13 | 13 | 13 | 13 | 13 | 13 | 13 | 13 |
| | Crank | 50 | 50 | 50 | 50 | 50 | 50 | 50 | 50 | 50 |
| | Pedals | 34 | 34 | 34 | 34 | 34 | 34 | 34 | 34 | 34 |
| | Battery holder | 6-8 | 6-8 | 6-8 | 6-8 | 6-8 | 6-8 | 6-8 | 6-8 | 6-8 |
| | Battery lock | 6-8 | 6-8 | 6-8 | 6-8 | 6-8 | 6-8 | 6-8 | 6-8 | 6-8 |
| | Derailleur / chain tensioner | 8-10 | 8-10 | 8-10 | 8-10 | 8-10 | 8-10 | 8-10 | 8-10 | 8-10 |
| Brakes | Brake calliper / disc brake | 6 | 6 | 6-8 | 4 | 6-8 | 6-8 | 4 | 6-8 | 6-8 |
| | Cassette | 30-50 | 30-50 | 30-50 | 30-50 | 30-50 | 30-50 | 30-50 | 30-50 | 30-50 |
| Saddle | Seat frame | 12 (8) | 12 (8) | 8 | 12 (8) | 8 | 10 | 12 (8) | 8 | 10 |
| | Seat post clamp | 6-7 | 6-7 | 6-7 | 6-7 | 6-7 | 6-7 | 6-7 | 6-7 | 6-7 |
| Rear fork | Rocker on seat tube | - | - | - | 8-10 | 8-10 | 8-10 | 8-10 | 8-10 | 8-10 |
| | Remaining screws | - | - | - | 13-15 | 13-15 | 13-15 | 13-15 | 13-15 | 13-15 |

- () Torque figures in brackets apply to optional parts.
- Failure to observe the specified torque figures can result in damage to parts. You should therefore always adhere to the prescribed torque.
- A torque spanner must be used for fastening screw connections. Parts tightened with the incorrect torque may loosen or break.

Onderdelen van de FLYER



- ① Zadel
- ② Zadelpen
- ③ Zadelpenklem
- ④ Veerelement/demper achtervork
- ⑤ Accu
- ⑥ Uitvaleinde/Pad
- ⑦ Achterderailleur
- ⑧ Ketting
- ⑨ Elektrische aandrijving
- ⑩ Crank
- ⑪ Pedaal
- ⑫ Scharnierpunt/lager
- ⑬ Frame
- ⑭ Balhoofd
- ⑮ Stuur met handvat
- ⑯ Display

- ⑰ Schakelhendel
- ⑱ Remhendel
- ⑲ Remkabel/-leiding
- ⑳ Schakelkabel
- ㉑ Balhoofdlager
- ㉒ Voorvork (geveerd)
- ㉓ Remklauw
- ㉔ Remschijf

Wiel

- ⑳ Voorwielnaaf
- ㉖ Spaak
- ㉗ Velg
- ㉘ Band
- ㉙ Ventiel

Technische gegevens voor Uproc2, Uproc4 en Uproc7 modeljaar 2017

Neem de onderstaande technische gegevens in acht wanneer u een FLYER van modeljaar 2017 hebt aangeschaft. De technische gegevens uit de gebruikershandleiding zijn voor deze modellen niet van toepassing.

Gewicht FLYER (zonder accu)

| | |
|----------|--------|
| – Uproc2 | 21 kg* |
| – Uproc4 | 22 kg* |
| – Uproc7 | 22 kg* |

*Het daadwerkelijke gewicht is afhankelijk van frametype, framemaat en uitvoering.

E-bikes van het type FLYER zijn ontworpen op een maximaal totaalgewicht (fietser, bagage, fiets en accu) van 130 kg.

Accu's voor de FLYER-modellen

| Capaciteit | Energie-inhoud | Gewicht |
|------------------------------------|----------------|----------------------|
| SIB Smart Integrated Battery 8 Ah | 288 Wh | 2,3 kg frame-accu |
| SIB Smart Integrated Battery 12 Ah | 432 Wh | 3,1 kg frame-accu |

Uitvoeringen Panasonic-middenmotor

| Motor | Trapondersteuning tot | Nom. continu-vermogen in watt | Max. output ketting-schakeling in watt | Max. ondersteuning kettingschakeling in % | Max. koppel ketting-schakeling in Nm |
|---------------------------|-----------------------|-------------------------------|--|---|--------------------------------------|
| (2-speed) 36V Multi Speed | 25 km/h | 250 | 600 | 300 | 66 |
| (2-speed) 36V Multi Speed | 45 km/h | 250 | 600 | 300 | 75 |

NL

Aanhaalmomenten voor bouten

| Waarden in Nm | | Uproc2 | | | Uproc4 | | | Uproc7 | | |
|---------------------------|---------------------------|--------|--------|-------|--------|-------|-------|--------|-------|-------|
| | | 4.10 | 6.30 | 8.70 | 4.10 | 6.30 | 8.70 | 4.10 | 6.30 | 8.70 |
| Cockpit | Handvatten | 3 | 3 | 3 | 3 | 2 | 2 | 2 | 2 | 2 |
| | Remhendel | 4 | 4 | 6-8 | 4 | 6-8 | 6-8 | 4 | 6-8 | 6-8 |
| | Schakelhendel | 3 | 3 | 3 | 3 | 3 | 3 | 3 | 3 | 3 |
| | Display-houder | 1 | 1 | 1 | 1 | 1 | 1 | 1 | 1 | 1 |
| | Bedieningseenheid display | 1 | 1 | 1 | 1 | 1 | 1 | 1 | 1 | 1 |
| | Stuur op balhoofd | 5-6 | 5-6 | 5-6 | 5-6 | 5-6 | 5-6 | 5-6 | 5-6 | 5-6 |
| | Stuurvoorbouw op vorkbuis | 5-6 | 5-6 | 5-6 | 5-6 | 5-6 | 5-6 | 5-6 | 5-6 | 5-6 |
| | Bouten motor | 30-35 | 30-35 | 30-35 | 30-35 | 30-35 | 30-35 | 30-35 | 30-35 | 30-35 |
| Aandrijving | Bouten kettingblad | 13 | 13 | 13 | 13 | 13 | 13 | 13 | 13 | 13 |
| | Crank | 50 | 50 | 50 | 50 | 50 | 50 | 50 | 50 | 50 |
| | Pedaal | 34 | 34 | 34 | 34 | 34 | 34 | 34 | 34 | 34 |
| | Accuhouder | 6-8 | 6-8 | 6-8 | 6-8 | 6-8 | 6-8 | 6-8 | 6-8 | 6-8 |
| | Accuslot | 6-8 | 6-8 | 6-8 | 6-8 | 6-8 | 6-8 | 6-8 | 6-8 | 6-8 |
| Derailleur/kettingspanner | 8-10 | 8-10 | 8-10 | 8-10 | 8-10 | 8-10 | 8-10 | 8-10 | 8-10 | |
| Remmen | Remklauw/schijfrem | 6 | 6 | 6-8 | 4 | 6-8 | 6-8 | 4 | 6-8 | 6-8 |
| | Cassette | 30-50 | 30-50 | 30-50 | 30-50 | 30-50 | 30-50 | 30-50 | 30-50 | 30-50 |
| Zadel | Zadelpen | 12 (8) | 12 (8) | 8 | 12 (8) | 8 | 10 | 12 (8) | 8 | 10 |
| | Zadelpenklem | 6-7 | 6-7 | 6-7 | 6-7 | 6-7 | 6-7 | 6-7 | 6-7 | 6-7 |
| Achter-vork | Zadelbrug op zadelpen | - | - | - | 8-10 | 8-10 | 8-10 | 8-10 | 8-10 | 8-10 |
| | Overige bouten | - | - | - | 13-15 | 13-15 | 13-15 | 13-15 | 13-15 | 13-15 |

- () Aanhaalmomenten in klemmen gelden voor optionele componenten.
- Niet in acht nemen van de voorgeschreven aanhaalmomenten kan beschadiging van onderdelen tot gevolg hebben. Houd u daarom altijd aan de aangegeven aanhaalmomenten.
- Voor het vastdraaien van de bouten moet een momentsleutel worden gebruikt.
- Niet correct vastgedraaide onderdelen kunnen los raken of breken.

FLYER

Biketec AG
Schwende1
CH-4950 Huttwil

T +41 62 959 55 55
info@flyer.ch
www.flyer-bikes.com

Ihr FLYER Fachhändler